

**Exhibit B: Project Notifications**

(7 pages)

# NOTICE OF A PROPOSAL & NOTICE OF PUBLIC MEETING

By Silvercreek Solar Park Inc. to Engage in a Renewable Energy Project

Dated at Malahide Township, this 18th of November, 2009

Silvercreek Solar Park Inc. is proposing the development of a new 10MW ground mounted solar photovoltaic facility on privately held lands in the Township of Malahide, Elgin County, 9 km south of the town of Aylmer. The project utilizes polycrystalline solar photovoltaic panels mounted on single-axis trackers to maximize energy production. A new 4.5 km distribution line will be built along existing municipal road easements to the point of connection with the Dunboyne Distribution Station. ORTECH Environmental has been retained to assist in the Renewable Energy Approvals process.

The project is subject to the provisions of the Environmental Protection Act Part V.0.1 and Ontario Regulation 359/09 and requires a Renewable Energy Approval as a Class 3 Solar Facility. A Draft Project Description Report titled "Project Description Silvercreek Solar Park" describing the facility will be posted on the proponent's website ([www.silvercreeksolar.com](http://www.silvercreeksolar.com)) on December 11, 2009. A written copy of the report will be available at the public meeting for review. This notice must be distributed in accordance with section 15 of the Regulation prior to an application being submitted and assessed by the Ministry of the Environment. Public consultation is an integral component of this process.

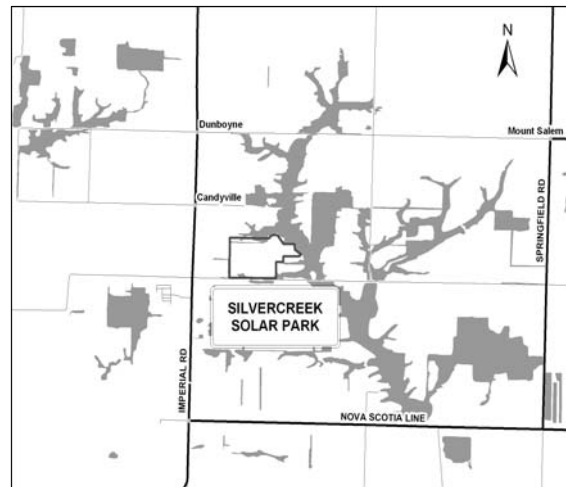

The first **Open House** is scheduled for:

**Date:** Friday, **December 18, 2009**

**Time:** **4pm to 8pm**

**Place:** German Canadian Club  
522 Talbot St.W.  
Aylmer, ON  
(519)-773-5271

For further information on this project, public meetings or to communicate concerns, please contact:

Leah Deveaux  
**ORTECH Environmental**  
804 Southdown Road  
Mississauga, ON; L5J 2Y4  
Phone: (905)822-4120 ext. 305; 1-877-774-6560  
Email: [info@silvercreeksolar.com](mailto:info@silvercreeksolar.com)  
**[www.silvercreeksolar.com](http://www.silvercreeksolar.com)**

Information will be collected and used in accordance with the Freedom of Information and Protection of Privacy Act, and solely for the purpose of assisting Silvercreek Solar Park Inc. in meeting Renewable Energy Approvals requirements. This material will be maintained on file for use during the study and may be included in project documentation. With the exception of personal information, all comments will become part of the public record.





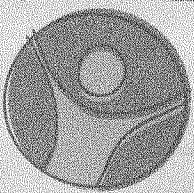

**talbot trail**  
PHYSIOTHERAPY

**Knee, foot or back pain?  
We do orthotics!**

Talbot Trail Physiotherapy has  
been making orthotics in  
Elgin County for over 8 years!

**CALL TODAY to book your assessment!**

Talbot Trail Physiotherapy  
102-460 Wellington Street,  
St. Thomas ON N5R 6H9  
T. 519.637.1831 F. 519.637.1832

Talbot Trail Physiotherapy & Rehabilitation  
5-424 Talbot Street West,  
Aylmer ON N5H 1K9  
T. 519.773.7400 F. 519.773.7410

Talbot Trail Physiotherapy & Musculoskeletal Center  
189 Elm Street (STEGH),  
St. Thomas ON N5R 5C4  
T. 519.637.7171 F. 519.637.7727

*Elgin County's Source for Quality Physiotherapy and Musculoskeletal Services*

## NOTICE OF A PROPOSAL & NOTICE OF PUBLIC MEETING

By Silvercreek Solar Park Inc. to Engage in a Renewable Energy Project  
Dated at Malahide Township, this 18th of November, 2009

Silvercreek Solar Park Inc. is proposing the development of a new 10MW ground mounted solar photovoltaic facility on privately held lands in the Township of Malahide, Elgin County, 9 km south of the town of Aylmer. The project utilizes polycrystalline solar photovoltaic panels mounted on single-axis trackers to maximize energy production. A new 4.5 km distribution line will be built along existing municipal road easements to the point of connection with the Dunboyne Distribution Station. ORTECH Environmental has been retained to assist in the Renewable Energy Approvals process.

The project is subject to the provisions of the Environmental Protection Act Part V.0.1 and Ontario Regulation 359/09 and requires a Renewable Energy Approval as a Class 3 Solar Facility. A Draft Project Description Report titled "Project Description Silvercreek Solar Park" describing the facility will be posted on the proponent's website ([www.silvercreeksolar.com](http://www.silvercreeksolar.com)) on December 11, 2009. A written copy of the report will be available at the public meeting for review. This notice must be distributed in accordance with section 15 of the Regulation prior to an application being submitted and assessed by the Ministry of the Environment. Public consultation is an integral component of this process.

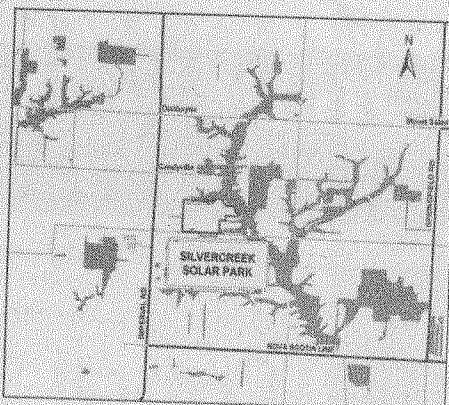

The first **Open House** is scheduled for:

**Date:** Friday, December 18, 2009

**Time:** 4pm to 8pm

**Place:** German Canadian Club  
522 Talbot St. W.  
Aylmer, ON  
(519) 773-5271

For further information on this project, public meetings or to communicate concerns, please contact:

Leah Deveau  
**ORTECH Environmental**  
804 Southdown Road  
Mississauga, ON; L5J 2Y4  
Phone: (905)822-4120 ext. 305; 1-877-774-6560  
Email: [info@silvercreeksolar.com](mailto:info@silvercreeksolar.com)  
[www.silvercreeksolar.com](http://www.silvercreeksolar.com)

Information will be collected and used in accordance with the Freedom of Information and Protection of Privacy Act, and solely for the purpose of assisting Silvercreek Wind Energy LP in meeting Renewable Energy Approvals requirements. This material will be maintained on file for use during the study and may be included in project documentation. With the exception of personal information, all comments will become part of the public record.

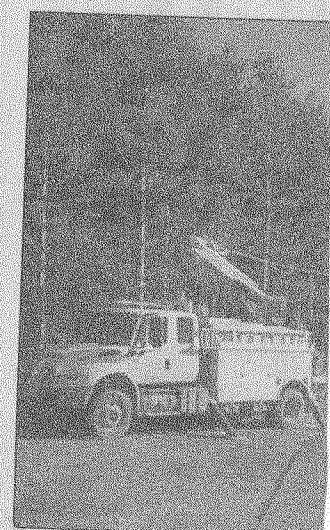
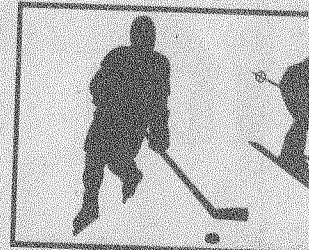
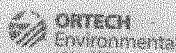

Two Aylmer Hydro One e  
stall soccer nets with a H  
Columbus Soccer Field,  
youths play soccer there e

## OWHA S Blazers re

by Dean Pressey

Friday, Nov. 13

**Blazers 1 - London**

**Devilettes Senior "AA" 1**

First-period scoring for the  
London Devilettes: Katly  
Maddigan from Jer  
VanAarsen (power play).

Second-period scoring for  
the Blazers: Jo-Dee Regier from  
Kaitlin Schuster and Kriste  
Harris (power play).

Scoring for Strathroy: Laur  
Bass from Carly Parker and  
Katie Parker.

Shelley Kuntz went the dis  
tance between the pipes for the  
Blazers.

## Archer

Golden Feather Archery  
Club results for Saturday, Nov  
14, 2009 were as follows:

High bird: Don Catt

Side birds: Allen Franklin  
and Donna Howe;

Kale birds: Jim Howe and

**sum  
ROCK**  
NURTURE

**Manicures • Pedicure  
Laser Hair Removal**

Erin Lynch - Esthetician

**FAMILY  
PRACTICE**

**Dr. Shahree  
OPTOM**

• Comprehensive  
• Contact Lens



**We've lost  
853 lbs in the  
last 6 months!**

**Join today and start losing with us!**

**Your first month is on us!**

"Herbal Magic is the best program out  
there. I am so confident in it that I've  
made it my career!"





Dine in our serene setting in the pines  
and enjoy our delicious

# Christmas Luncheon

reservations  
until December 23rd

*Enjoy a homecooked dinner  
with all the trimmings!*

8122 Rogers Rd. South, Aylmer  
**519-773-3435**

## OWHA Senior "AA"

by Dean Pressey  
**Friday, Dec. 4**  
**Blazers 4 – St. Thomas**  
**Senior "AA" 1**

First-period scoring for the Blazers: Shannon Wise from Nicole Osborne and Kaitlin Schuster; Wise from Osborne and Leanne Tunks.

Second-period scoring for the Blazers: Samantha Newman-Thody from Brittany Rogers and Kristen Harris (power play).

Third-period scoring for the Blazers: Kathryn Grasso from Carly Polci and Kari Hilton.

Scoring for St. Thomas: Kathy Ramsey from Lexi Wilson and Renee Vansevenant (power play).

Shelley Kuntz went the distance between the pipes.

**Saturday, Dec. 5**  
**Blazers 5 – St. Thomas**  
**Midget "AA" 0**

First-period scoring for the Blazers: Rogers from Tunks and Newman-Thody (short-handed).

Second-period scoring for the Blazers: Grasso from Hilton and Danielle Aulenback (power play).

Third-period scoring for the Blazers: Grasso from Newman-Thody and Harris (power play);

Newman-Thody from Harris (short-handed) and Grasso (power play); Newman-Thody from Grasso (power play) and Rogers.

Deb Flaherty went the distance between the pipes for the shutout.

**Sunday, Dec. 6**

**Blazers 2 –**

**Markham Stouffville 3**

Second-period scoring for Markham: Kathy Tait from Nikki Chapman and Emily Muir (power play); Laurie McLellan from Amber Steeves

(short-handed) Morris (power play) Thir Blazers (power play) Pye an (power play). She the B

## Community two new shuffleboard

East Elgin Community Complex will be getting two new shuffleboard mats along with cues and discs in December.

At the Dec. 3 board of management meeting, General Manager Theresa Klachan said money was available to buy one mat and she was still waiting for word on an application to Aylmer Area Community Foundation requesting a grant to pay for a second.

The mats cost about \$1,500 each.

She was responding to

### Cy's Old Timers

There were nine bowlers at the lanes on Tuesday, Dec. 8, 2009.

Lucky ladies were Donna Goble with 183 and Evelyn

comm Wilso numb shuffle the deter regul not e play T mats M mon pay wait com gran seco S shul befo info C was

## AMANDA DEWAELE, RMT

— REGISTERED MASSAGE THERAPIST —

### NOTICE OF A PROPOSAL & NOTICE OF PUBLIC MEETING

By Silvercreek Solar Park Inc. to Engage in a Renewable Energy Project  
Dated at Malahide Township, this 18th of November, 2009

Silvercreek Solar Park Inc. is proposing the development of a new 10MW ground mounted solar photovoltaic facility on privately held lands in the Township of Malahide, Elgin County, 9 km south of the town of Aylmer. The project utilizes polycrystalline solar photovoltaic panels mounted on single-axis trackers to maximize energy production. A new 4.5 km distribution line will be built along existing municipal road easements to the point of connection with the Dunboyne Distribution Station. ORTECH Environmental has been retained to assist in the Renewable Energy Approvals process.

The project is subject to the provisions of the Environmental Protection Act Part V.0.1 and Ontario Regulation 359/09 and requires a Renewable Energy Approval as a Class 3 Solar Facility. A Draft Project Description Report titled "Project Description Silvercreek Solar Park" describing the facility will be posted on the proponent's website ([www.silvercreeksolar.com](http://www.silvercreeksolar.com)) on December 11, 2009. A written copy of the report will be available at the public meeting for review. This notice must be distributed in accordance with section 15 of the Regulation prior to an application being submitted and assessed by the Ministry of the Environment. Public consultation is an integral component of this process.

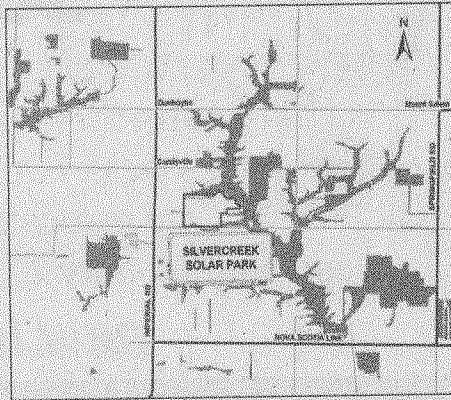

The first **Open House** is scheduled for:

**Date:** Friday, December 18, 2009

**Time:** 4pm to 8pm

**Place:** German Canadian Club  
522 Talbot St. W.  
Aylmer, ON  
(519)-773-5271

For further information on this project, public meetings or to communicate concerns, please contact:

Leah Deveaux  
**ORTECH Environmental**  
804 Southdown Road  
Mississauga, ON; L5J 2Y4  
Phone: (905)822-4120 ext. 305; 1-877-774-6560  
Email: [info@silvercreeksolar.com](mailto:info@silvercreeksolar.com)  
[www.silvercreeksolar.com](http://www.silvercreeksolar.com)

Information will be collected and used in accordance with the Freedom of Information and Protection of Privacy Act, and solely for the purpose of assisting Silvercreek Solar Park Inc. in meeting Renewable Energy Approvals requirements. This material will be maintained on file for use during the study and may be included in project documentation. With the exception of personal information, all comments will become part of the public record.

**ORTECH**  
Environmental  
a division of ORTECH Consulting Inc.

2

### 2005 Jeep Grand

Laredo Rocky Mount  
4X4, 4.7, V8, Heated Leather  
Tow Package. 96,  
**\$16,495**

3

### 2004 GMC E

4X4, 4L, Six Cylinder, P  
Heated Leather, 5  
**\$17,995**

4

**We Service &  
What W**

*Come on in and see the boys at  
Goodwill's  
where all the vehicles are windshield priced*

**Goodwill's**  
**USED**  
420 Talbot St. E. Aylmer  
[goodwillssus](http://goodwillssus.com)



## NOTICE OF CHANGE TO A PROPOSAL

By Silvercreek Solar Park Inc. to Engage in a Renewable Energy Project  
Dated at Malahide Township, this 16 December 2011

Silvercreek Solar Park Inc. is proposing the development of a new 10MW ground mounted solar photovoltaic facility on privately held lands in the Township of Malahide, Elgin County, 9 km south of the town of Aylmer. The project utilizes polycrystalline solar photovoltaic panels mounted on single-axis trackers to maximize energy production. A new 15 km distribution line will be built along the existing municipal road right of way. In addition, a 115kV substation will be constructed to facilitate a connection to the Aylmer TS. ORTECH Environmental has been retained to assist in the Renewable Energy Approvals process.

The project is subject to the provisions of the Environmental Protection Act Part V.0.1 and Ontario Regulation 359/09 and requires a Renewable Energy Approval as a Class 3 Solar Facility.

An original Notice of Project was distributed in December 2009. A Draft Project Description Report titled "Project Description Silvercreek Solar Park" describing the facility is available on the proponent's website ([www.silvercreeksolar.com](http://www.silvercreeksolar.com)). A hardcopy of the report is available upon request.

This notice reflects changes to the original project design notice in order to accommodate a longer distribution line route and the inclusion of a new Substation.

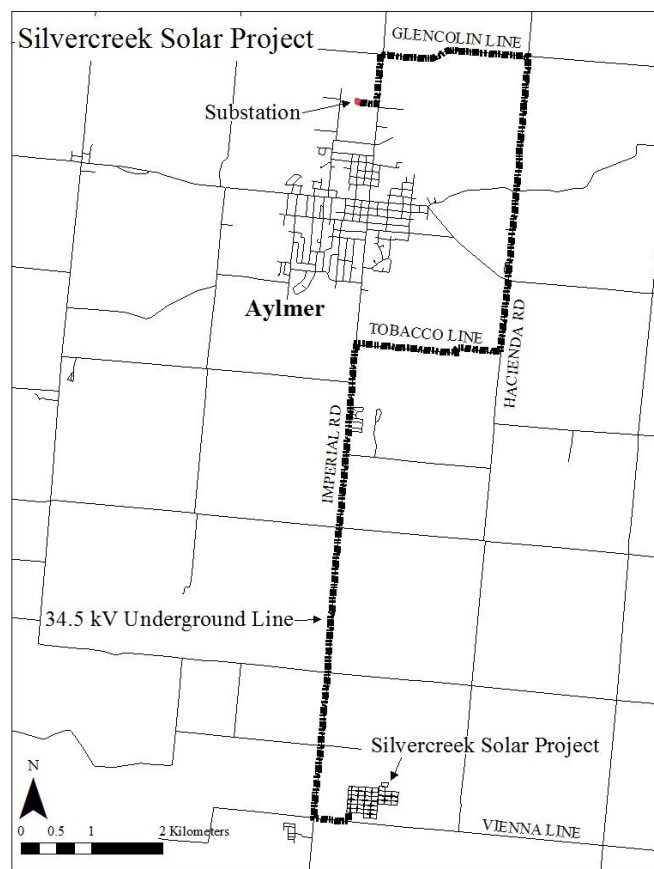

For further information on this project, public meetings or to communicate concerns, please contact:

Leah Deveau

**ORTECH Environmental**

804 Southdown Road

Mississauga, ON; L5J 2Y4

Phone: (905)822-4120 ext. 305; 1-877-774-6560

Email: [info@silvercreeksolar.com](mailto:info@silvercreeksolar.com)

**[www.silvercreeksolar.com](http://www.silvercreeksolar.com)**

Information will be collected and used in accordance with the Freedom of Information and Protection of Privacy Act, and solely for the purpose of assisting Silvercreek Solar Park Inc. in meeting Renewable Energy Approvals requirements. This material will be maintained on file for use during the study and may be included in project documentation. With the exception of personal information, all comments will become part of the public record.



# NOTICE OF PUBLIC MEETING

To be held by Silvercreek Solar Park Inc. regarding a Proposal to Engage in a Renewable Energy Project

Project Name: Silvercreek Solar Park Inc.  
Project Location: Malahide Township (see map)  
Dated at Malahide Township this 2<sup>nd</sup> day of August 2012

Silvercreek Solar Park Inc. is planning to engage in a renewable energy project in respect of which the issuance of a renewable energy approval (REA) is required. The proposal to engage in the project and the project itself is subject to the provisions of the Environmental Protection Act (ACT) Part V.0.1 and the Ontario Regulation 359/09 (Regulation). This notice must be distributed in accordance with section 15 of the Regulation prior to an application being submitted and assessed for completeness by the Ministry of the Environment.

**Meeting Location:** **Date:** October 4, 2012  
**Time:** 5:30pm – 8pm  
**Place:** German Canadian Club  
522 Talbot St. West; Aylmer, ON

**Project Description:** Pursuant to the Act and Regulation, the facility, in respect of which this project is to be engaged in, is a Class 3 ground mounted Solar Facility. If approved, this facility would have a total maximum name plate capacity of 10 MW. The project location is described in the map below. Additionally, the project will require installation of a new 34.5kV distribution line to be installed primarily below ground, to a new 115kV substation adjacent to the existing Aylmer Transmission Station.

**Documents for Public Inspection:** The Draft Project Description Report titled "Project Description: Silvercreek Solar Park" describes the project as utilizing up to 46,000 polycrystalline solar photovoltaic panels, with a rated power output of 290 W, each to be mounted on horizontal beam single-axis trackers totaling 10 MW. The project will require installation of a new 34.5kV distribution line to be installed primarily below ground to a new 115kV substation adjacent to the existing Aylmer Transmission Station. A written copy of the Draft Project Description Report was made available for public inspection on November 18, 2009.

Further, the applicant has prepared supporting documents in order to comply with the requirements of the Act and Regulation. Written copies of the draft supporting documents will be made available for public inspection on August 2, 2012 at the following locations:

**Elgin County Library – Aylmer Branch, 38 John St. South Aylmer and [www.silvercreeksolar.com](http://www.silvercreeksolar.com)**

To learn more about the project please contact:

**Silvercreek Solar Park Inc. c/o**  
Leah Deveau  
ORTECH Power  
804 Southdown Rd. Mississauga ON; L5J 2Y4  
Phone: 1-877-774-6560 ext. 305  
Email: [info@silvercreeksolar.com](mailto:info@silvercreeksolar.com)  
**[www.silvercreeksolar.com](http://www.silvercreeksolar.com)**

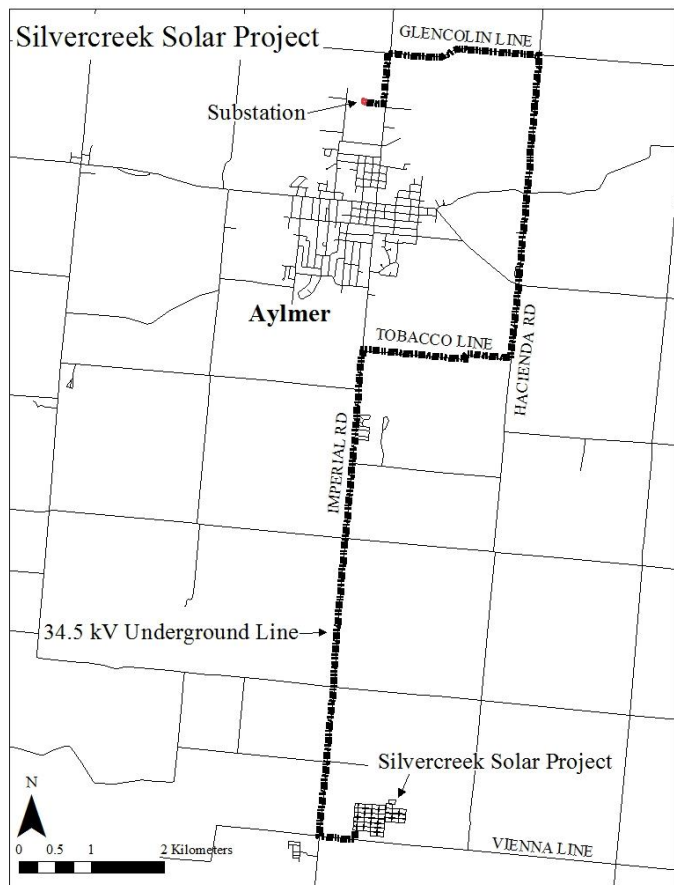

Information will be collected and used in accordance with the Freedom of Information and Protection of Privacy Act, and used solely for the purpose of assisting Silvercreek Solar Park Inc. in meeting their Renewable Energy Approvals requirements. This material will be maintained on file for use during the study and may be included in project documentation. With the exception of personal information, all comments will become part of the public record.





Aylmer's Evan Thompson used a hula hoop during his turn on the catwalk in Clovermead Adventure Farm's eighth annual Bee Beard and Pioneer Games Festival Saturday, July 28. While Mr. Thompson, an actor and lay clergyman with Our Lady of Sorrows Catholic Church, didn't win the competition, he was

more than game. His beard creation started with the disadvantage of losing the queen bee hung around his neck to attract other bees to his beard. The queen was eventually found and strapped with dental floss in her cage around his neck.

(AE/Craig Bradford)



Emma Johnston, 9, front, and her father Chris of London take a turn at cross-cut sawing, one of the activities at Clovermead Adventure Farm's eighth annual Bee Beard and Pioneer Games Festival held on Saturday, July 28. The event is a fundraiser for Aylmer's Perc Café which is run by the not-for-profit organization Career Opportunities for Elgin Youth and staffed by its clients. Clovermead's Chris Hiemstra said \$3,826 was raised for the Perc at the event which attracted over 400 visitors. He said a big thank you goes out to the volunteers who helped with the Pioneer Games, parking and beekeeping during the bee beard competition. (AE/Craig Bradford)



West Elgin Mayor Bernie Wiehle, left, was crowned champion by Chris Hiemstra at Clovermead Adventure Farm's eighth annual Bee Beard and Pioneer Games Festival Satur-

day, July 28. Chef Jonathan Collins, who now resides in Tillsonburg but has lived in Port Bruce, won the crowd pleaser plaque.

(AE/Craig Bradford)



**Jeff Yurek, MPP**  
Elgin-Middlesex-London

Here to help you with any of the following provincial matters  
Monday through Friday, 10:00-4:30

- Ontario Disability Support Program
- OHIP Cards • Driver's Licences
- Ontario Works • Birth Certificates

P: 519-631-0666 • T: 1-800-265-7638  
750 Talbot St., Unit 201  
St. Thomas, ON N5P 1E2  
www.jeffyurekmpp.com  
jeff.yurek@pc.ola.org



## Malahide fire calls

July 24, Summers Corners station, Hacienda Road, motor-vehicle collision.

July 24, Mount Salem station assisted by Summers Corners, Springfield and Lyons stations, Levi Street, fire.

July 24, Summers Corners station, Conservation Line, medical assist.

July 25, Springfield station assisted by Mount Salem, Summers Corners and Lyons stations, Ashton Street, fire.

July 25, Mount Salem station, Bank Street, medical assist.

July 25, Mount Salem station, Dexter Line, medical assist.

July 28, Springfield station, Springfield Road, medical assist.

July 28, Summers Corners station, Talbot Line, medical assist.

July 29, Summers Corners station, Hacienda Road, medical assist.

July 29, Springfield station assisted by Summers Corners station, College Line, motor-vehicle collision.

### EMISSION TESTING AND REPAIRS



Cars and Trucks

**Goodwill Repairs Ltd.**  
420 Talbot St. E.  
**519-773-9607**

**ADVANCED MOTORSPORTS LTD.**

**44583 Dexter Line**  
15 min. South of St. Thomas

**HOURS: Mon.-Fri. – 8 am - 6 pm**  
**Sat. – 9 am - 1 pm • CLOSED SUNDAYS**

**Service • Parts • Accessories**

**All Major Brands**

- Factory Trained Technicians
- Full Machine Shop
- Pick-up and Delivery Available



Dean Parker  
Service Technician

**519-782-7155**  
www.advancedyamaha.com

**YAMAHA**

## NOW IS THE TIME TO IMPROVE YOUR HOME

See our Showroom for Windows, Doors, Siding, Railings, Shutters, Storm Doors

**Strassburger**  
WINDOWS AND DOORS

**GENTEK**



**UNIQUE INSTALLATIONS**  
DIVISION OF ALUVIN CONTRACTING LTD.  
A Family Business Since 1979  
Call John Brouwer, Owner  
519-631-8183 • 1-800-513-3660  
Hwy#3, 1/2 km east of St. Thomas (across from Dowler-Karr)

Come to the experts!  
MasterCard VISA

## NOTICE OF PUBLIC MEETING

To be held by Silvercreek Solar Park Inc. regarding a Proposal to Engage in a Renewable Energy Project

Project Name: Silvercreek Solar Park Inc.  
Project Location: Malahide Township (see map)  
Dated at Malahide Township this 2<sup>nd</sup> day of August 2012

Silvercreek Solar Park Inc. is planning to engage in a renewable energy project in respect of which the issuance of a renewable energy approval (REA) is required. The proposal to engage in the project and the project itself is subject to the provisions of the Environmental Protection Act (ACT) Part V.0.1 and the Ontario Regulation 359/09 (Regulation). This notice must be distributed in accordance with section 15 of the Regulation prior to an application being submitted and assessed for completeness by the Ministry of the Environment.

**Meeting Location:** **Date:** October 4, 2012  
**Time:** 5:30pm – 8pm  
**Place:** German Canadian Club  
522 Talbot St. West; Aylmer, ON

**Project Description:** Pursuant to the Act and Regulation, the facility, in respect of which this project is to be engaged in, is a Class 3 ground mounted Solar Facility. If approved, this facility would have a total maximum name plate capacity of 10 MW. The project location is described in the map below. Additionally, the project will require installation of a new 34.5kV distribution line to be installed primarily below ground, to a new 115kV substation adjacent to the existing Aylmer Transmission Station.

**Documents for Public Inspection:** The Draft Project Description Report titled "Project Description: Silvercreek Solar Park" describes the project as utilizing up to 46,000 polycrystalline solar photovoltaic panels, with a rated power output of 290 W, each to be mounted on horizontal beam single-axis trackers totaling 10 MW. The project will require installation of a new 34.5kV distribution line to be installed primarily below ground to a new 115kV substation adjacent to the existing Aylmer Transmission Station. A written copy of the Draft Project Description Report was made available for public inspection on November 18, 2009.

Further, the applicant has prepared supporting documents in order to comply with the requirements of the Act and Regulation. Written copies of the draft supporting documents will be made available for public inspection on August 2, 2012 at the following locations:  
**Elgin County Library – Aylmer Branch, 38 John St. South Aylmer and www.silvercreeksolar.com**

To learn more about the project please contact:

**Silvercreek Solar Park Inc. c/o**  
Leah Deveau  
ORTECH Power  
804 Southdown Rd. Mississauga ON; L5J 2Y4  
Phone: 1-877-774-6560 ext. 305  
Email: info@silvercreeksolar.com  
**www.silvercreeksolar.com**

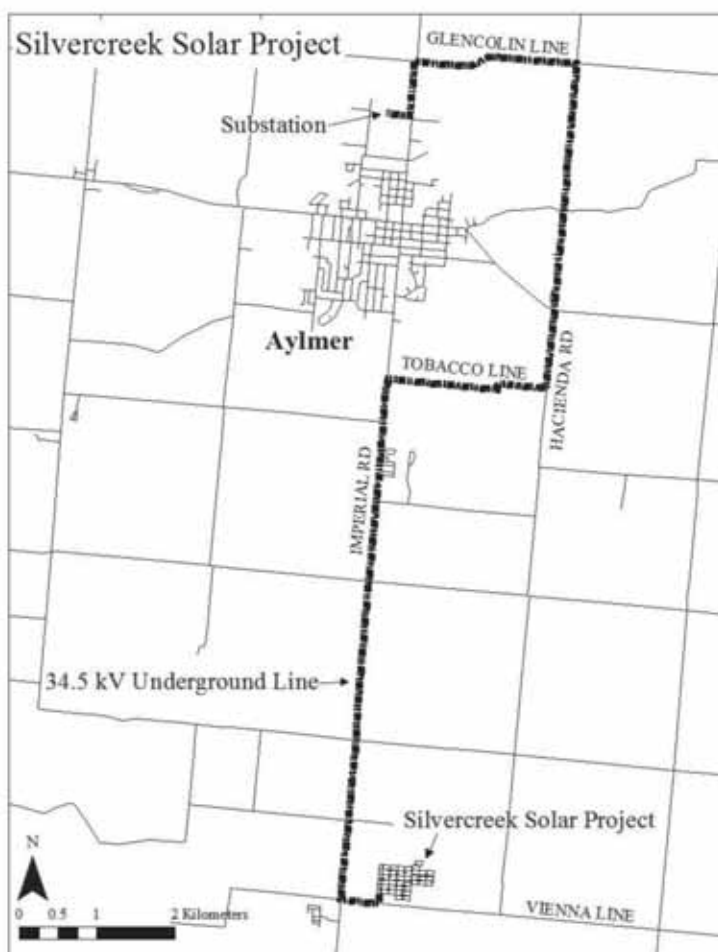

## Welcoming Ruben Wiebe & Kerry Kerr to the McTaggart Armstrong Team of Insurance Brokers

Ruben is a life long Aylmer resident and is *fluent in Low German*. Ruben is a Registered Insurance Broker who looks forward to helping you with your Home, Auto, Farm & Business Insurance needs.



Kerry, also a life long resident of Aylmer, is pleased to be a Registered Insurance Broker and is eager to assist you and your family with your Home and Auto Insurance needs.

**Ruben & Kerry join our team with an appreciation for our Community.**

Stop by today to say hello to Ruben and Kerry and find out how McTaggart Armstrong can save you money and maximize your security.

**McTAGGART, ARMSTRONG, DEWAR & OWEN**  
**INSURANCE BROKERS**

HOME • AUTO • FARM • BUSINESS

90 Talbot Street West, Aylmer

**519-773-8401 1-800-505-5622**





# Boy, 6, mauled by dog

CONTINUED FROM PAGE 1  
on the south side. The dog's owner accompanied him.

"I knew that the owner couldn't get the dog off the boy," Mr. Thompson said. She hurt her wrist attempting to control her dog. He then took the dog and its owner to her home and left them on the home's back porch.

Mr. Thompson was told by others at the scene that the dog jumped over the fence on the east side of the house which is located two properties west of Victoria on the south side of the street.

"That's the second time the dog has gotten out," he said.

Mr. Thompson told the dog's owner he didn't want to hurt her pet.

"In a way I feel for the dog," he said. "I had to do what I had to do to get the dog off the boy. In my experience that big a dog in town should be muzzled. And it's lucky the boy had the helmet on."

Mr. Thompson estimated the dog weighed more than 150 pounds but could have been even bigger. The average male Rottweiler dog is about 130 pounds.

**Hero?**

While he has heard some local residents describe his actions as heroic, Mr. Thompson said that's not how he looks at it. "I just did what anyone else would do. I have a girlfriend with two young kids. I was just lucky I was there. If I wasn't it could have turned out worse."

The victim's grandfather said Mr. Thompson "deserves a medal" for pulling the dog off his grandson. He added the fact his grandson was wearing a bicycle helmet prevented the dog from biting into his skull.

Aylmer Police Chief Andre Reymer said the boy was visiting friends in Aylmer along with his family at the time of the attack.

He and a four-year-old were bicycling on a sidewalk, with an adult watching from nearby, on Sydenham Street East when the Rottweiler from a house across

the street jumped a 1.5-metre (four and a half foot) fence and chased after them.

The dog owner was outside and was shocked by her dog's action, Chef Reymer said. She chased after it and caught it briefly, but it broke free and attacked the six-year-old, who had fallen to the ground.

The dog first bit the boy's head and then his leg, Chief Reymer said.

"The dog wouldn't let go of the child," he said. "It grabbed onto his leg and wouldn't let go."

Mr. Thompson grabbed the dog by the collar and hauled it off the child, forcing the animal back across the street into the owner's home, Chief Reymer said, while the boy was taken into a nearby home at 241 Sydenham St. East where first-aid was administered until police, firefighters and paramedics arrived.

The boy was taken to St. Thomas Elgin General Hospital and then later transferred to London for additional treatment.

**"Good spirits"**

He was released Saturday, Chief Reymer said, and seemed "in remarkably good spirits" despite the attack.

The dog had no previous record of such behaviour, Chief Reymer said. "It was a shock to all."

The dog owner was "very co-operative and remorseful," Chief Reymer said, and offered to immediately have the three-year-old animal euthanized.

But instead, at the request of officials at Elgin St. Thomas Public Health, the dog is being quarantined in a cage in the owner's home for the next 10 days to see if the animal exhibits any transferable diseases such as rabies before a decision is made about its fate.

An investigation under the Dog Owners' Liability Act was under way, Chief Reymer said.

A neighbour of the dog owner, Harry Hewbank, said this is the first time he knew of a dog at the house causing a

problem.

"No, never," Mr. Hewbank told The Aylmer Express when asked if the dog in question had ever been a concern to him. "As a matter of fact, we recently commented that we've never heard him bark, ever."

Mr. Hewbank said there are two dogs at his neighbour's home.

**No prior problems**

"Before (Friday), we never even knew they were there," Mr. Hewbank said. "If they got out they just stayed by the house. (The attack) was something new. We've never had any problems at all with the dogs. It's surprising."

Chief Reymer said he too was surprised that the attack happened.

"It was a suitable size fence (for a dog) in our opinion," Chief Reymer said. "We have no records on file of aberrant behaviour from this animal. It is a first-time occurrence."

Despite the events of Friday, Chief Reymer said the boy was feeling well enough to stop by the Aylmer Police Station with his family for a visit during the East Elgin Doors Open event on Saturday afternoon.

"He was in surprisingly good spirits," Chief Reymer said.

As for the boy's injuries, he said, "I can't give you a stitch count, but it was significant."

The Aylmer Police will now coordinate their investigation with Elgin St. Thomas Public Health, Chief Reymer said, adding if it is determined the dog should be destroyed an order would probably have to be issued unless the owners decide to euthanize it on their own.

Chief Reymer felt the current arrangement for containing the animal was safe.

"He's being kept inside in a kennel," he said. "We don't believe there is an immediate risk to the community."

Chief Reymer cautioned anyone not to approach any large pets, but if it becomes unavoidable, to not make any "sudden actions."



Aylmer resident John Thompson stands on the site just south of the intersection of Sydenham Street East and Victoria Street where he pulled a three-year-old male Rottweiler dog off of a six-year-old Tillsonburg boy on the afternoon of Friday, Sept.

(AE/Craig Bradford)

"Animals are unpredictable," he said. "Do not approach stray animals, especially in groups. All animals have a pack mentality."

Children who encounter large animals and are concerned should go to a house they feel safe approaching, especially if there is a Block Parent sign in the window, Chief Reymer said.

**Leash a must**

In Aylmer, dogs must be under the control of their owners and be leashed so the animal cannot stray more than three metres, Chief Reymer said, although this isn't a bylaw the police often enforces.

"Generally unleashed dogs aren't a problem," Chief Reymer said. "Most people we see walking their dogs are conscientious owners. We address it when it becomes a matter of concern."

There is no criterion listed in the bylaw to his knowledge about how high or strong a fence should be to contain an animal.

"This yard was definitely fenced," he said. "(The owners) did have a contained animal that unfortunately got out."

Chief Reymer added the incident could have been much worse and thanked Mr. Thompson for his efforts to separate the dog from the boy.

"All parties involved were interested in the child's interests first," he said.



**Wear a Helmet!**



Pictured is the fence adjacent to a Sydenham Street East home in Aylmer that a three-year-old male Rottweiler dog is believed to have jumped before attacking a six-year-old Tillsonburg boy on the afternoon of Friday, Sept. 21.

(AE/Craig Bradford)

The boy was bicycling in the area during the time of the attack and was eventually taken to St. Thomas Elgin General Hospital and later transferred to a London hospital for additional treatment before he was released on Saturday.

Ill-fitting dentures can affect enjoyment of food, less or alterations in the type of food consumed can influence digestion and overall general health. This combined with any existing medical conditions, can cause unnecessary health complications.

Poorly designed dentures can lead to a variety of problems:

- Poor Emotional and Psychological Health – ill-fitting dentures can make it difficult to socialize
- Joint and Jaw Disorders – caused by excessive tooth wear

The Conrad Denture Clinic provides a variety of denture options to accommodate your lifestyle and budget. We want to be your practitioner of choice, and we'll restore your appetite for a healthier lifestyle. Call us today at 519-631-2299.

**CONRAD DENTURE CLINIC**

519-631-2299 | www.teeth4u.ca



Aylmer Police Constable Colbert Seupersaud "arrested" April LaRoche of Jersey Photography last Friday morning. She was taken to an ad hoc jail in St. Thomas, where she had to telephone friends to ask for "bail money," actually donations

to Crime Stoppers. That program offers financial rewards for information leading to arrests and convictions in actual crimes.

(AE/Rob Perry)

## Tax critic warns of pending property assessment changes

Bill MacIntyre, a former Springfield reeve and one of the leaders of a Malahide taxpayer revolt, urged township councillors last week to warn property owners of forthcoming reassessment across the municipality.

The reassessment would be conducted by the Municipal Property Assessment Corporation, which he knew wasn't under council's control.

However, he said, someone had to take the lead warning residents what was coming.

The valuations in the reassessment would be based on each property's value as of Sept. 1, he said.

Notices from MPAC would start being mailed out Nov. 9, he said, and property owners had to scrutinize them carefully.

He owned nine acres of farmland, he said, and previously severed a half-acre for his daughter's house.

In a subsequent assessment notice, he found he supposedly owned 17.5 acres.

Instead of subtracting a half acre from his assessment, he said, MPAC had somehow added together how much he used to own and how much he owned after the severance to get 17.5.

Many property owners didn't read their notices and would

never have seen that, he said.

MPAC admitted its mistake, he added, but he still had to file a formal appeal to get the assessment changed.

Mr. MacIntyre said the last time his mother's property was reassessed, the supposed value of her Springfield home jumped to \$190,000 from \$129,000.

He researched sales of similar properties in the village, filed an appeal and the value was changed to \$143,000.

If that hadn't been done, he said, his mother would have ended up paying an additional \$600 a year in property tax.

He understood from a recent

MPAC presentation to councillors that the projected value of farmland in this area was going up 60 percent over the next four years, and houses 12 percent.

Councillor Mark Wales, who's also president of Ontario Federation of Agriculture, warned farmers to check not just the values of their homes and land, but other buildings as well.

A bunkhouse that was vacant or used only seasonally might end up classed as a more expensive residential home, and other buildings might end up in commercial or industrial classes.

"Check everything," he urged.

### NOTICE OF PUBLIC MEETING

To be held by Silvercreek Solar Park Inc. regarding a Proposal to Engage in a Renewable Energy Project

Project Name: Silvercreek Solar Park Inc.  
Project Location: Malahide Township (see map)  
Dated at Malahide Township this 26th day of September 2012

Silvercreek Solar Park Inc. is planning to engage in a renewable energy project in respect of which the issuance of a renewable energy approval (REA) is required. The proposal to engage in the project and the project itself is subject to the provisions of the Environmental Protection Act (ACT) Part V.0.1 and the Ontario Regulation 359/09 (Regulation). This notice must be distributed in accordance with section 15 of the Regulation prior to an application being submitted and assessed for completeness by the Ministry of the Environment.

**Meeting Location:** **Date:** October 4, 2012  
**Time:** 5:30pm – 8pm  
**Place:** German Canadian Club  
522 Talbot St. West; Aylmer, ON

Project Description: Pursuant to the Act and Regulation, the facility, in respect of which this project is to be engaged in, is a Class 3 ground mounted Solar Facility. If approved, this facility would have a total maximum name plate capacity of 10 MW. The project location is described in the map below. Additionally the project will require installation of a new 34.5kV distribution line to be installed primarily below ground to a new 115kV substation adjacent to the existing Aylmer Transmission Station.

**Documents for Public Inspection:** The Draft Project Description Report titled "Project Descriptions: Silvercreek Solar Park" describes the project as utilizing up to 46,000 polycrystalline solar photovoltaic panels with a rated power output of 290 W each to be mounted on horizontal beam single-axis trackers totaling 10 MW. The project will require installation of a new 34.5kV distribution line to be installed primarily below ground to a new 115kV substation adjacent to the existing Aylmer Transmission Station. A written copy of the Draft Project Description report was made available for public inspection on November 18, 2009.

Further, the applicant has prepared supporting documents in order to comply with the requirements of the Act and Regulation. Written copies of the draft supporting documents will be made available for public inspection on August 2, 2012 at the following locations: **Elgin County Library – Aylmer Branch, 38 John St. South Aylmer and www.silvercreeksolar.com**

To learn more about the project please contact:  
**Silvercreek Solar Park Inc. c/o**  
Leah Deveaux  
ORTECH Power  
804 Southdown Rd. Mississauga ON; L5J 2Y4  
Phone: 1-877-774-6560 ext. 305  
Email: info@silvercreeksolar.com  
**www.silvercreeksolar.com**

Information will be collected and used in accordance with the Freedom of Information and Protection of Privacy Act, and used solely for the purpose of assisting Silvercreek Solar Park Inc. in meeting their Renewable Energy Approvals requirements. This material will be maintained on file for use during the study and may be included in project documentation. With the exception of personal information, all comments will become part of the public record.

